



SINCE 1974

# Weatherproof Start-stop Push Button Station

● Technical Data : WLC 10 16 803

**CERTIFICATION :**  
CIMFR/TC/P/H734

**COMPONENT :**

- A) CONTACT ELEMENT 10A, 415V, AC / 1A, 250V, DC
- B) STOP PUSH BUTTON, STAY PUT TYPE RED MUSHROOM HEAD WITH WITHOUT KEY LOCKABLE 1NC / 2NC CONTACT - 1 No.
- C) START PUSH BUTTON GREEN SHROUDED WITH 1NO / 2NO CONTACT - 1 No.
- D) MICRO TERMINALS, CLIPON TYPE RAIL MOUNTED 2.5 Sq.mm x 4 Nos.  
Max. TERMINALS 2.5 Sq.mm x 8 Nos.

**CABLE ENTRY :**

- M20 x 1 No. (AS STANDARD)
- M20 x 2 Nos. (ON REQUEST)

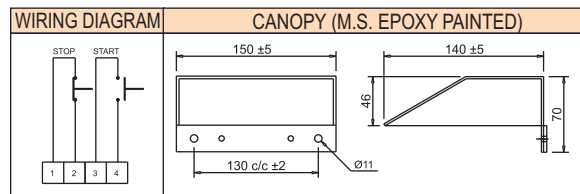
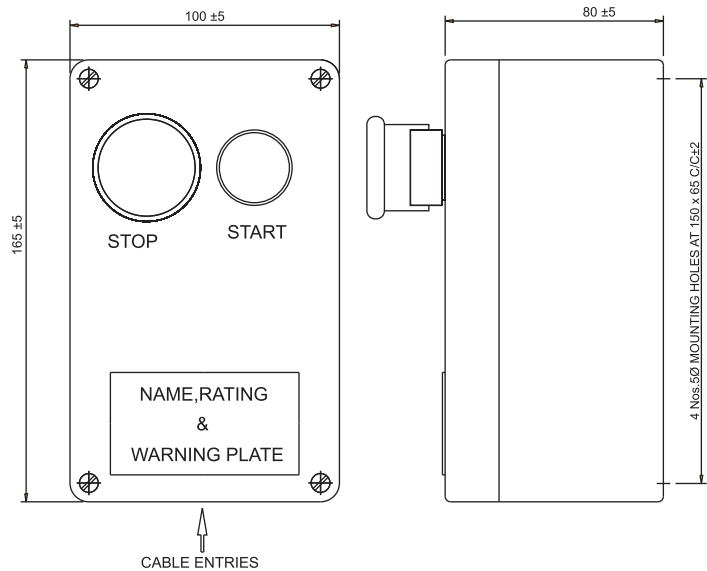

# Weatherproof Switch

● Technical Data : WLC 10 16 804

**CERTIFICATION :**  
CIMFR/TC/P/H734

**COMPONENT :**

- A) UP TO 25A SELECTOR SWITCH A-O-M SP/DP - 1No.
- B) MICRO TERMINALS CLIPON TYPE RAIL MOUNTED 2.5 Sq.mm x 3Nos.  
Max. TERMINALS 2.5 Sq.mm x 8 Nos.

**CABLE ENTRY :**

- M20 x 1 No (AS STANDARD)
- M20 x 2 Nos ( AS ON REQUEST)

