

# COPPER REDUCER TERMINALS

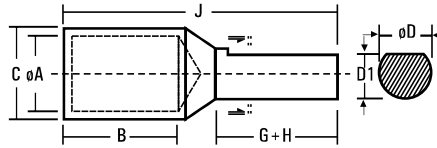

MM <sup>2</sup>	øA	øC	øD	D-1	B	K	G-H	J	Dowell's CAT. No.	RECOMMENDED TOOLS & DIES					STD PKG			
										SYB- 95	SYD- 20A	SYT- 150A	SYE- 150 B	SYT-102 R				
2.5	2.5	4.7	3.8	3.3	6	4	10	20	WPC-7	<b>LINE CONNECTORS</b>					200			
4.0	2.8	4.7	3.8	3.3	6	4	10	20	WPC-16						SYA-427	SYT-17	SYT-2	200
6.0	3.1	4.7	3.8	3.3	6	4	10	20	WPC-18									200
10	3.8	5.5	3.8	3.3	9	4	10	23	WPC-20									200
10	4.4	6.2	3.8	3.3	9	4	10	23	WPC-22	JBR-1					200			
16	5.3	7.1	3.8	3.3	13	4	13	30	WPC-2	JBR-2					200			
25	7.0	9.0	6.0	5.5	12	5	15	32	WPC-25	JBR-3					100			
35	8.0	10.0	7.5	6.5	12	5	20	37	WPC-4	JBR-4					100			
50	9.2	11.2	7.5	6.5	16	5	20	41	WPC-26	JBR-6					100			
70	11.3	13.8	7.5	6.5	18	5	20	43	WPC-27	JBR-7				HY-267	50			
95	12.8	15.6	11.5	10.5	20	6	25	51	WPC-29	JBR-9				HY-268	50			
120	14.8	17.8	11.5	10.5	22	6	32	60	WPC-35	JBR-10			JEA-120	HY-269	30			
150	16.0	19.6	11.5	10.5	26	6	32	64	WPC-37		JDR-11	JER-11	JEA-150	HY-270	20			
185	18.0	22.0	11.5	10.5	32	6	32	70	WPC-38		JDR-12	JER-12	JEA-185	HY-271	20			
225	20.0	26.0	15.6	14.0	38	8	32	78	WPC-39		JDR-14	JER-14	JEA-240	HY-272	10			
240	21.2	26.0	15.6	14.0	38	8	32	78	WPC-43		JDR-14	JER-14	JEA-240	HY-272	10			
300	24.0	28.7	16.0	15.0	42	8	42	92	WPC-45		JDR-15	JER-15	JEA-300	HY-273	10			
400	27.0	33.2	15.6	14.0	46	12	32	90	WPC-101			JER-17	JEA-400	HY-274	5			