

COPPER TUBE TERMINALS HEAVY DUTY - OPEN AT K



SYT -17



SYA - 427



SYT - 2



SYB - 95



SYD-20B



SYE - 150B



SYT 102

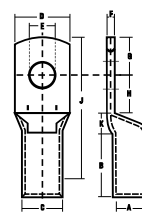

MM ²	E Bolt MMØ	øA	øC	D	F	B	K	H	G	J	Dowell's CAT. No.	SYB 95	SYD 20B	SYE 150B	SYT 102-R	STD PKG
2.5	M4	2.4	4.0	8	1.0	7	2	5	4	18	CUS-388					200
4.0	M5	3.1	4.8	10	1.0	7	2	6	5	20	CUS-389	SYA-427	SYT-17	SYT-2		200
6.0	M5	3.8	5.5	10	1.2	9	3	6	5	23	CUS-390					200
10	M6	4.5	6.2	12	1.2	9	3	7	6	25	CUS-353	JBR-1				200
16	M6	5.4	7.1	12	1.4	12	4	7	7	30	CUS-354	JBR-2				200
25	M6	6.8	8.8	13	2.0	12	4	7	7	30	CUS-355	JBR-3				100
35	M8	8.2	10.6	15	2.4	12	5	9	9	35	CUS-356	JBR-4				100
50	M8	9.5	12.4	18	2.9	16	6	11	10	43	CUS-357	JBR-6	JDA-50	JEA-50	HY-267	100
70	M10	11.2	14.7	21	3.5	18	7	13	12	50	CUS-358	JBR-7	JDA-70	JEA-70	HY-268	50
95	M10	13.5	17.4	25	3.9	20	9	13	13	55	CUS-359	JBR-10	JDA-95	JEA-95	HY-269	50
120	M12	15.0	19.4	28	4.4	22	10	14	14	60	CUS-241		JDA-120	JEA-120	HY-270	30
150	M12	16.5	21.2	30	4.7	26	11	16	16	69	CUS-242		JDA-150	JEA-150	HY-271	20
185	M16	18.5	23.5	34	5.0	32	12	17	17	78	CUS-243		JDA-185	JEA-185	HY-272	20
240	M16	21.0	26.5	38	5.5	38	14	20	20	92	CUS-244		JDA-240	JEA-240	HY-273	10
300	M16	23.5	30.0	43	6.5	42	15	22	22	101	CUS-245		JDA-300	JEA-300	HY-274	10
400	M16	26.8	34.8	50	8.0	44	18	26	26	114	CUS-246		JDA-400	JEA-400	HY-275	5
500	M20	30.0	39.0	56	9.0	48	20	28	28	124	CUS-247			JEA-500	JEM-279	5
630	M20	35.0	45.0	65	10.0	56	22	33	33	144	CUS-248			JEA-630	JEM-280	5

MATERIAL -EC GRADE COPPER IS -191

TOLERANCE=± 5%

FINISH - ELECTRO TINNED