

WE RESERVE THE RIGHTS AT ANY TIME TO MAKE ANY SPECIFICATION OR DIMENSIONAL CHANGES DEEMED NECESSARY TO ENSURE ADVANCEMENT IN THE DESIGN OR MANUFACTURE OF ANY PRODUCT

MM <sup>2</sup>	øA	øC	J	Dowell's CAT. No.	SYB 95	SYD 20A	SYE 150A	SYT 7	SYT 9	SYT 102 R	STD PKG
2.5	2.6	5.5	16	ALS-6	SYA-427						200
4.0	2.9	5.5	16	ALS-5	SYT-17						200
6.0	3.5	5.5	16	ALS-13	SYT-2				6		200
10	4.4	7.4	20	ALS-14	JBR-1				10		200
16	5.4	8.3	26	ALS-4	JBR-2				16		200
25	7.0	10.0	35	ALS-3	JBR-4				25		100
35	8.0	10.8	40	ALS-2	JBR-5				35		100
50	9.3	13.0	45	ALS-12	JBR-7				50	HY-267	100
70	11.6	16.0	55	ALS-1	JBR-9					HY-268	50
95	12.9	17.1	60	ALS-15	JBR-10					HY-269	50
120	14.8	19.6	65	ALS-9	JBR-11	JDR-11	JER-11	JEK-402		HY-270	30
150	16.1	21.2	70	ALS-10		JDR-12	JER-12	JEK-403		HY-271	20
185	18.0	23.7	75	ALS-11		JDR-13	JER-13	JEK-404		HY-272	20
225	20.6	27.0	85	ALS-147		JDR-14	JER-14	JEK-405		HY-273	10
240	22.0	28.0	90	ALS-16		JDR-15	JER-15	JEK-406		HY-273	10
300	24.0	31.0	100	ALS-17		JDR-16	JER-16	JEK-407		HY-274	10
400	28.0	36.0	115	ALS-18			JER-18	JEK-277		HY-275	5
500	30.0	41.0	125	ALS-19			JER-20			JEM-279	5
630	35.0	46.0	140	ALS-20			JER-21				5
800	39.0	51.0	160	ALS-148			JER-27				5
1000	43.5	57.0	210	ALS-149			JER-29				4

MATERIAL-ELECTROLYTIC ALUMINIUM IS 5082

TOLERANCE=± 5%

FINISH : NATURAL

## SOLDERING TYPE TUBE TERMINALS

AMPS	øE	øA	øC	D	F	B	K	H	G	J	Dowell's CAT. No.	STD. PKG.
60	6.4	8.1	9.5	14	1.4	14	4	9	9	36	DEW-203	100
100	9.5	10.9	12.7	19	1.8	19	8	11	11	49	DEW-204	50
150	9.5	13.9	15.9	24	2.0	23	8	13	13	57	DEW-205	30
200	12.7	16.6	19.0	28	2.4	27	11	14	14	66	DEW-206	20
300	12.7	19.0	22.2	33	3.2	28	13	20	19	80	DEW-207	20
400	15.9	22.2	25.4	38	3.2	32	15	21	21	89	DEW-208	10
500	19.0	25.4	28.6	43	3.2	38	17	25	25	105	DEW-209	10
600	19.0	27.8	31.8	47	4.0	44	17	27	27	115	DEW-210	10

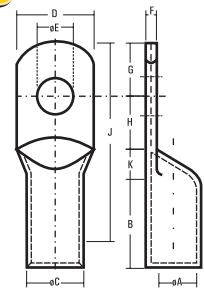

FINISH - ELECTRO TINNED

- 1) Terminals and splices covered in this catalogue are of standard series only. Please refer us for your tailor made requirements such a specific stud holes, Palm and Barrel lengths.
- 2) Dowell's products available for Railways duly approved by R.D.S.O., C.L.W., D.L.W., I.C.F. etc

MATERIAL-EC GRADE COPPER IS -191

TOLERANCE=± 5%